

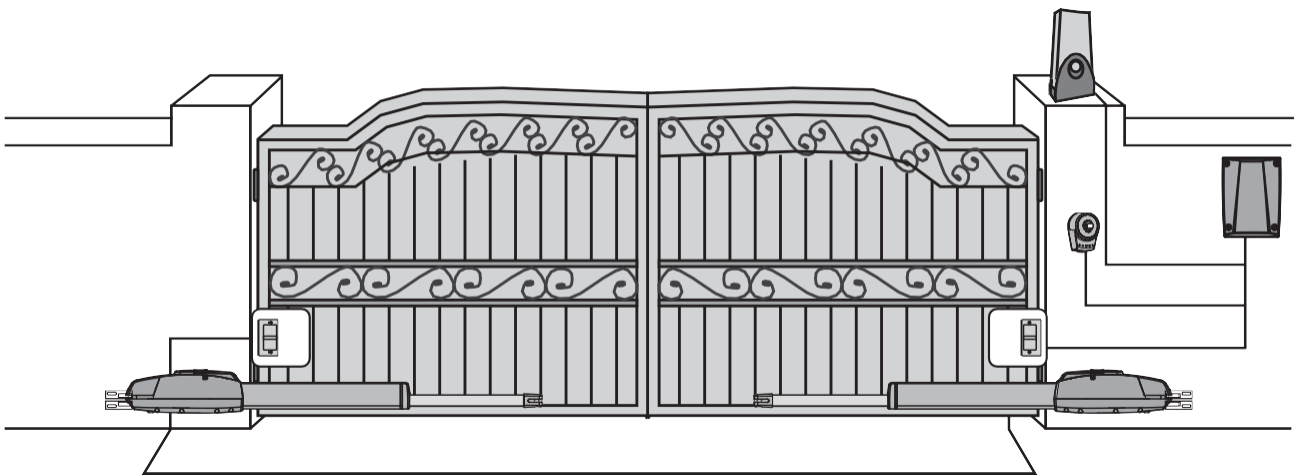

GTR500 & GTR501 SWING GATE OPENER

User Manual



Reuse
Reduce
Recycle



1.1 WARNING:

This user manual is only for qualified technicians who is specialized in installations and automations.

- (1) All installations, electrical connections, adjustments, and testing must be performed only after reading and understanding of all instructions carefully.
- (2) Before carrying out any installation or maintenance operation, disconnect the electrical power supply by turning off the magneto thermic switch connected upstream and apply the hazard area notice required by applicable regulations.
- (3) Make sure the existing structure is up to standard in terms of strength and stability.
- (4) When necessary, connect the motorized gate to reliable earth system during electricity connection phase.
- (5) Installation requires qualified personnel with mechanical and electrical skills.
- (6) Keep the automatic controls (remote, push bottom, key selectors...etc) placed properly and away from children.
- (7) Only original parts should be used for any repair or replacement. Any damage caused by incorrect parts and methods will not be covered under warranty.
- (8) Never operate the automated opener if you suspect that it might be faulty or damaged.
- (9) The motors are exclusively designed for the gate opening and closing application, any other use is deemed inappropriate. Improper usage should void all warranty, and the user accepts sole responsibility for any risks thereby may accrue.
- (10) The system may only be operated in proper working order. Always follow the standard procedures by following the instructions in this installation and operating manual.
- (11) Only command the remote when you have a full view of the gate.
- (12) A safety beam or photocell should be fitted to any automated opener.

Check your local council for regulations.

Please keep this installation manual for future reference.

CONTENTS

PART A: Gate Motor and Associated Parts	
Installation	4
A. Standard Installation	5
B. Dimension Chart	6
C. Motor Fixing	7
D. Wire Connection	7
E. Emergency Release	9
Technical Features	10
A. Technical Feature	10
B. Dimensions	10
Limit Switch Adjustment	11
Maintenance	11
PART B: GTR500, GTR501, GTR502, GTR503 Control System User Manual	
Control Box Installation	13
Wiring Connection	13
Motor Connection	14
Get Started	15
Step 1: Remote Learning	15
A. Learning	15
B. Remote Learning without Control Board	15
C. Deleting Memory of All Remotes	15
Step 2: System Learning	16
A. Dual Gate	16
B. Single Gate	16
Gate Moving Logic	17
Checking the Gate Movement	17
LED Indication	17
Function of the LED display	17
Parameter Learning	18
Parameter Setting	18
Technical Specification	22
Trouble Shooting	23
Technical Support	24

PART A:

Gate Motor and Associated Parts

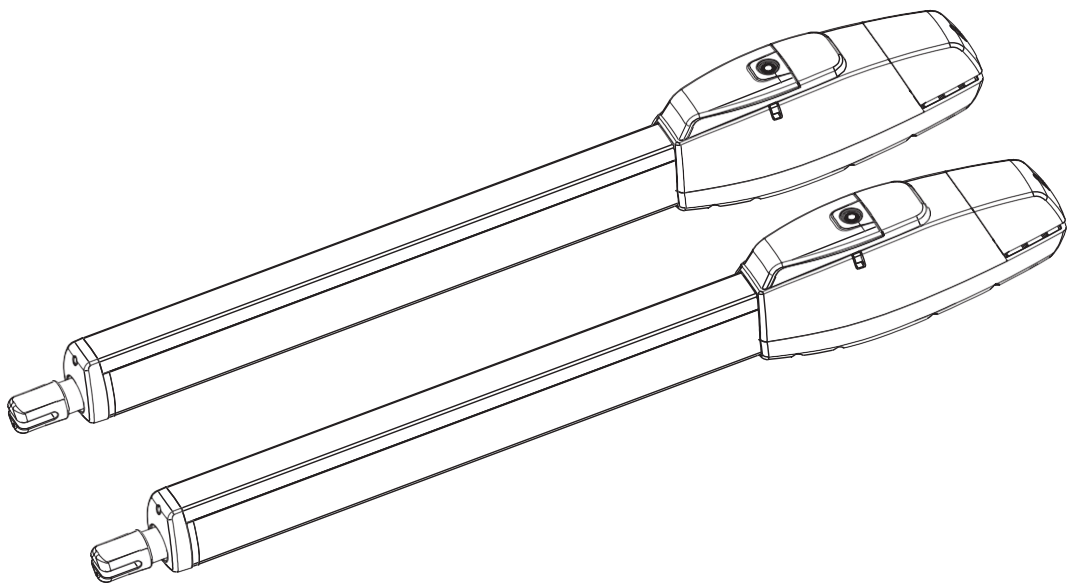

Standard Installation

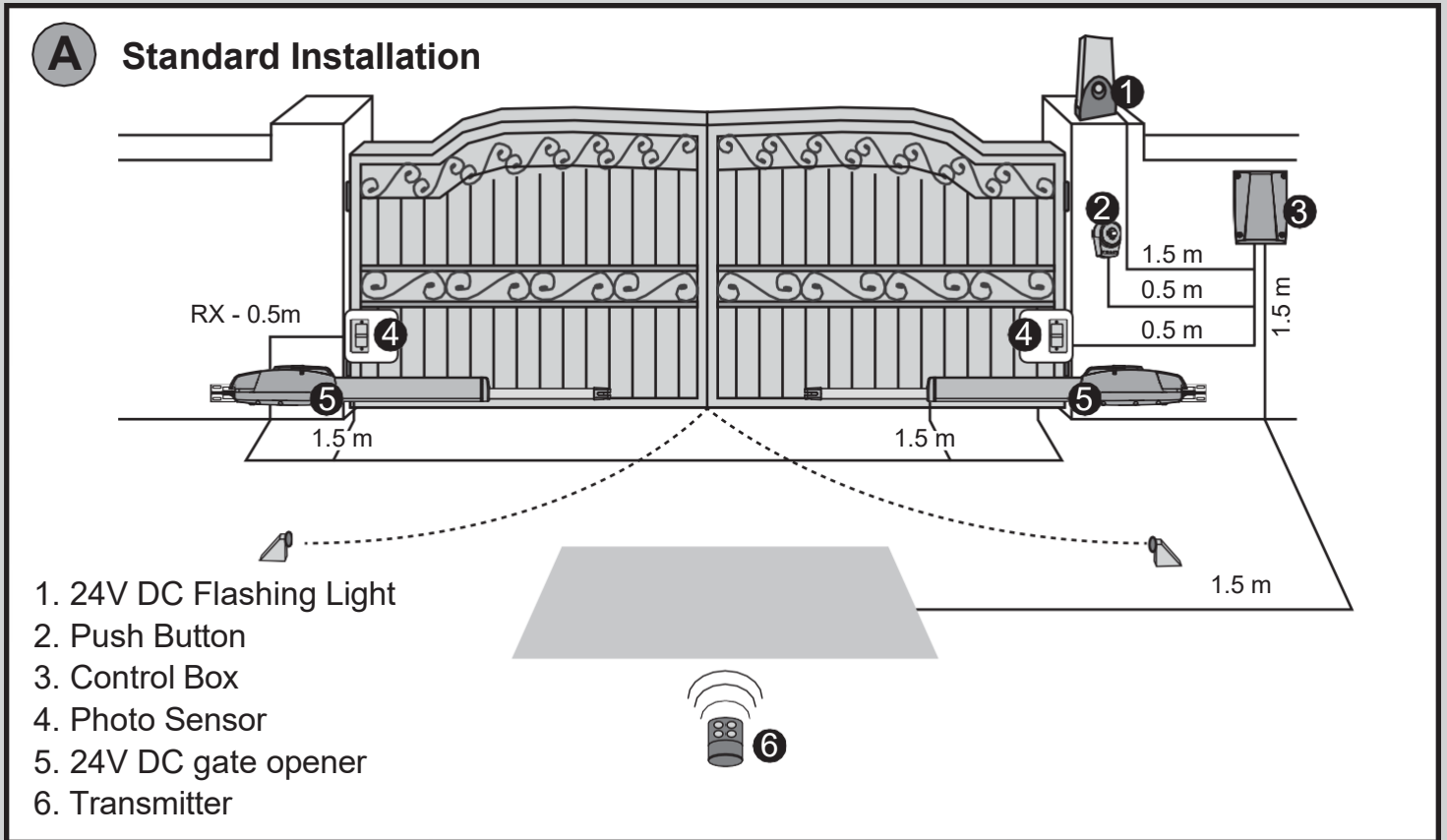

B Dimension Chart

Comply with the measures shown on the chart for proper installation.

Adjust the gate structure to fit for best automation, if necessary.

Before proceeding with installation, be sure that gate moves freely and that:

- 1) Hinges are properly positioned and greased.
- 2) No obstacles in the moving area.
- 3) No frictions between the two gate leaves, or with the ground while moving.
- 4). **“A” is measured front to back, from the gate hinge to the arm hinge point.**
- 5). **“B” is measured left to right, from the gate hinge to the arm hinge point.**
- 6). Ensure there are no pinch points and there is a minimum 60mm between the motor housing and the gate at all times.

**Please avoid mounting at minimum measurement points where possible.

Mounting closer to the middle of the table will reduce loading on the arm.

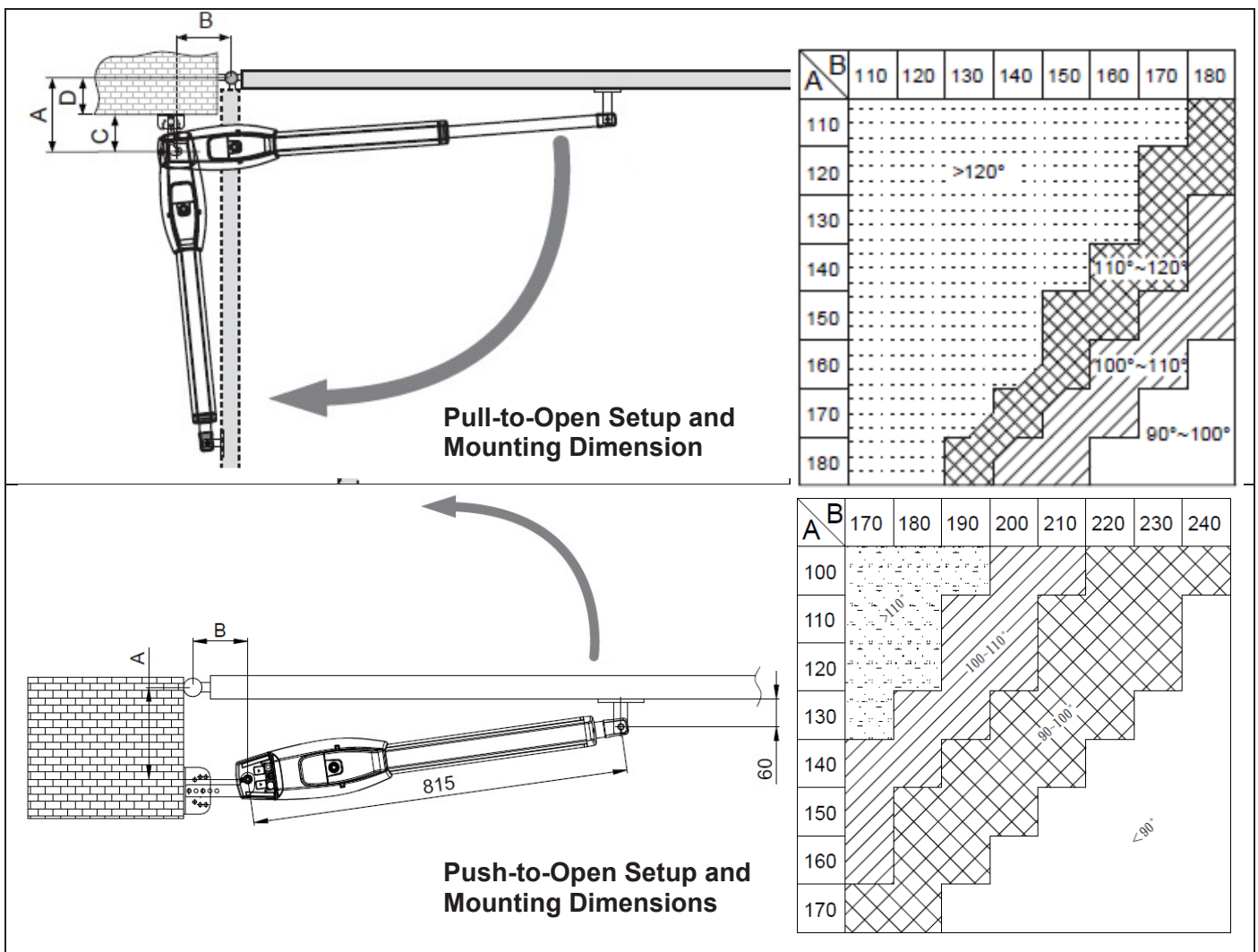

C Motor Fixing

Assemble the rear bracket and fix it on the pillar.

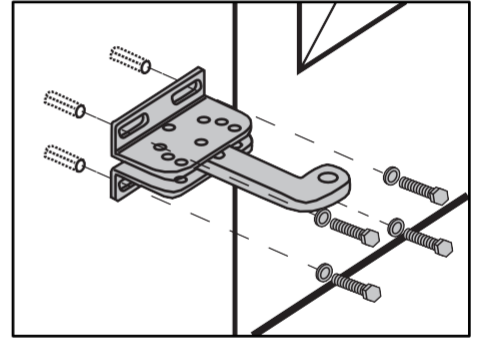
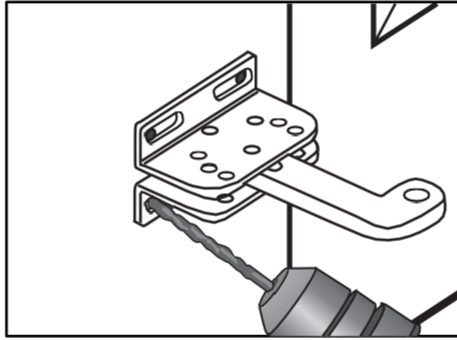
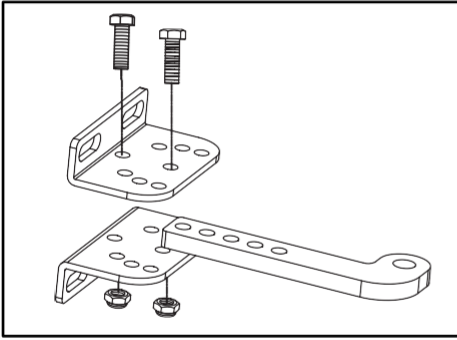

Remove the wire cover and fix the rear bracket with the pin. Release the gate opener and place the pin into the fitting position no.1 and no. 2

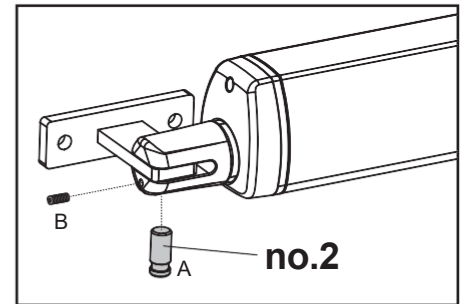
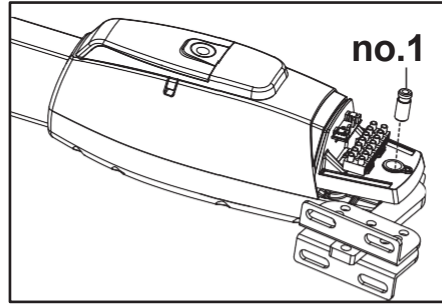
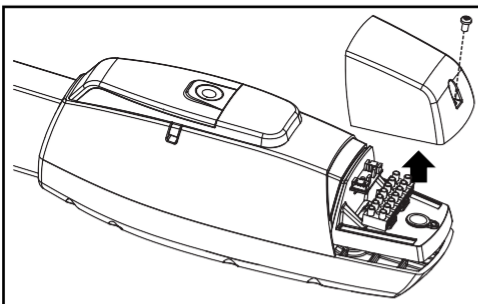

Make sure the gate openers are mounted in horizontal position especially in those positions.

- 1) When gate in CLOSE position
- 2) When gate in OPEN position
- 3) When gate at 45° angle position

If welding the bracket onto the gate leaf, cover or remove the gate opener to prevent damages from sparks.

D Wire Connection:

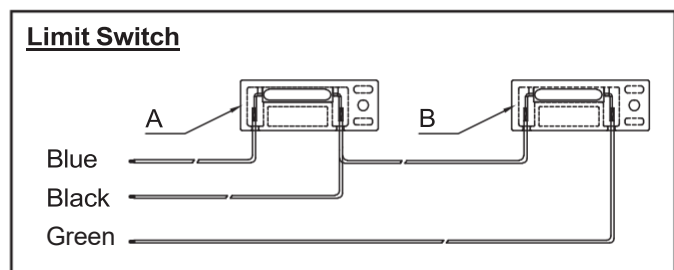
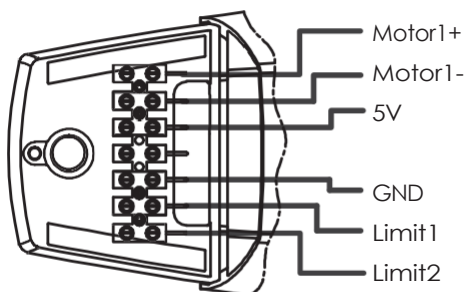

- (1) Avoid tension in the cable during open and close phase.
- (2) Always connect the grounding wire(GND)

Wire connection – Pull-to-Open

Left Motor

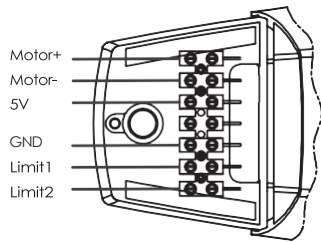

Right Motor

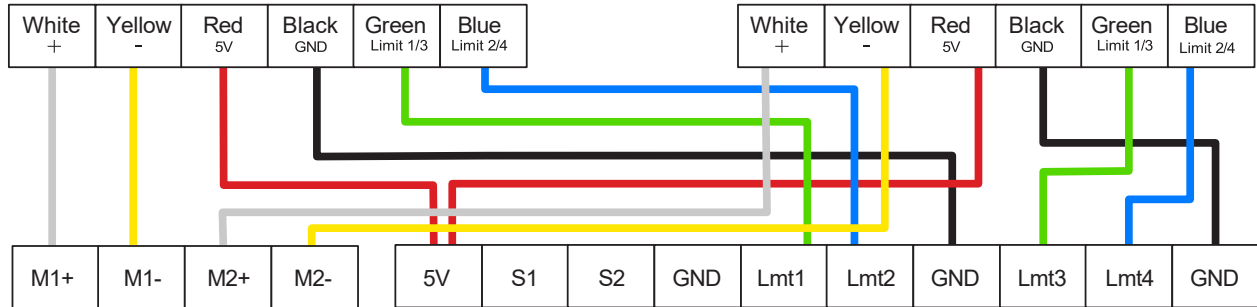
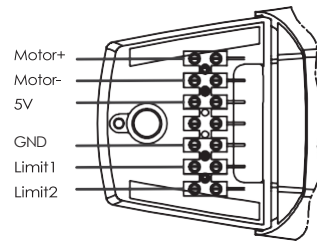

Terminals of the CB19 control panel

Wire connection – Push-to-Open

Left Motor

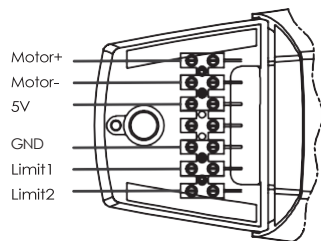

Right Motor

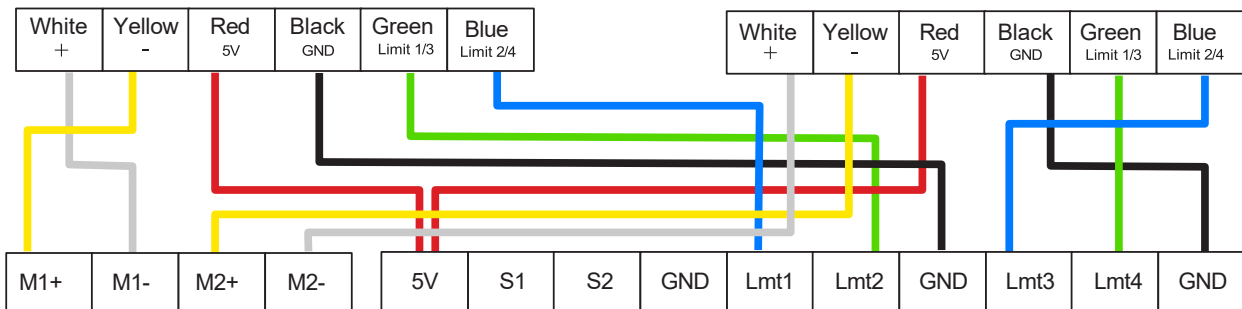
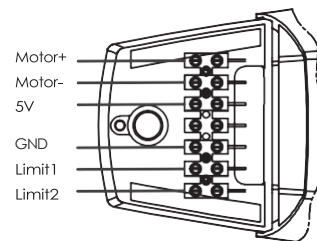

Terminals of the CB19 control panel

E Emergency Release

In case of power failure, push the lid of release chamber and move forward.

Insert the key and turn clockwise to unlock, then turn around the knob to release.

To restore the automation, simply reverse the above procedures.

Step1. Push the lid of release chamber and move forward

Step2. Insert the key and turn clockwise to the unlock position

Step3. then turn clockwise the knob to release the motor.

Make sure the White bar on the knob is on the position opposite to the triangle indication.

To restore the automation, simply reverse the above procedure.

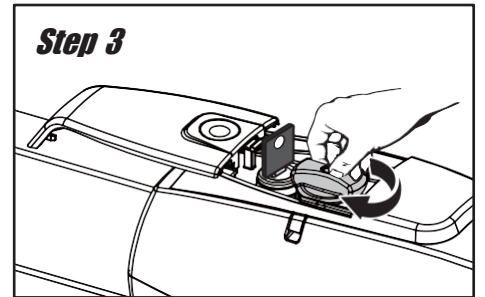
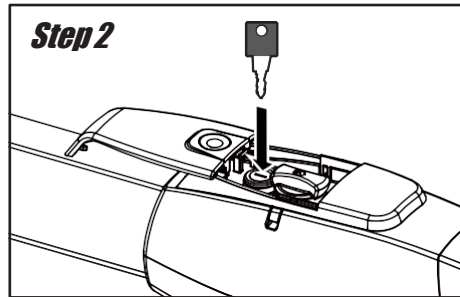
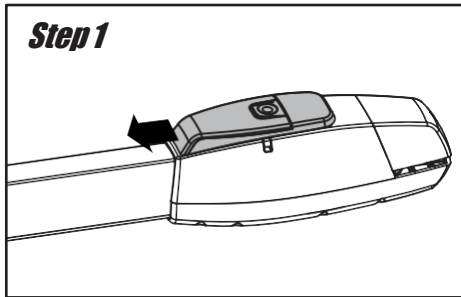
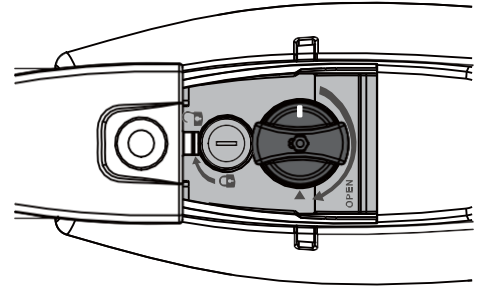

Technical Features :

A Technical Feature:

GTR500 & GTR501	
Max gate length	4m
Max gate weight	350kg
Power Supply	110V/230Vac (50-60Hz)
Motor Power Supply	24Vdc
Gear type	Worm gear
Peak Thrust	3,500N
Normal Thrust	3,000N
Operation Stroke	350mm
Piston extension	25.5mm/sec
Opening time	<14 sec
Duty Cycle	20%
Protection grade (IP)/ Protection class	IP44
Working temperature/ Operating temperature	-20~50
Absorbed current (A)	5.5A for maximum 10secs
Absorbed power (W)	144W
Manual release	key
Enclosure dimensions	917mm * 123mm * 124mm

B Dimension:

GTR500/GTR501

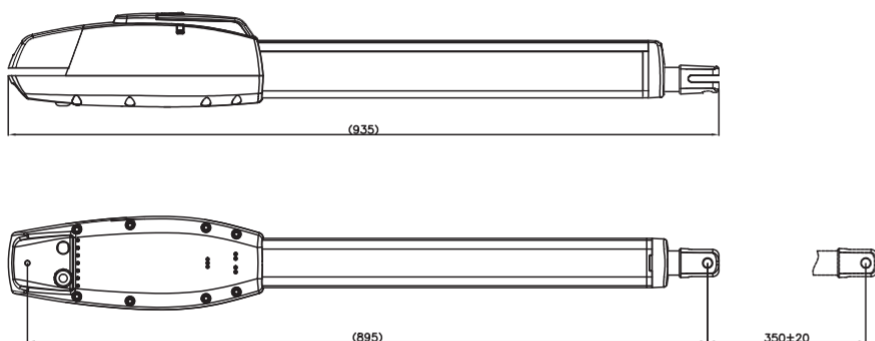

Limit switch adjustment

1. Remove the screw on the anti-shaking ring

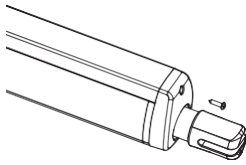

2. Turn the anti-shaking ring

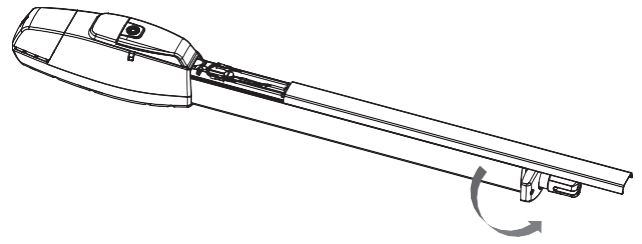

3. Remove the upper cover of the outer tube and reveal two Knobs of the front and rear limit switch

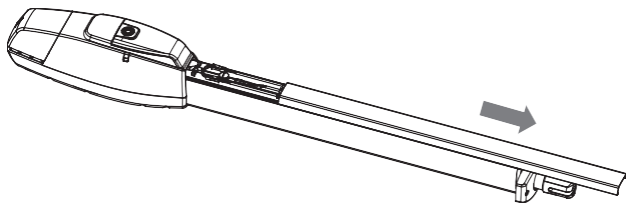

4. Adjust two Knobs to set the open and close position

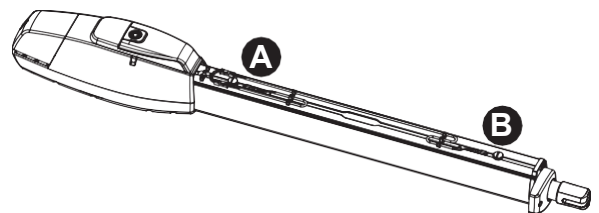

Opening position:

1. Loosen the screw of limit switch A by hand.
2. Slide the switch to the right position.
3. Tighten up the screw.

Closing position:

1. Loosen the screw of limit switch B by hand.
2. Slide the switch to the right position.
3. Tighten up the screw.

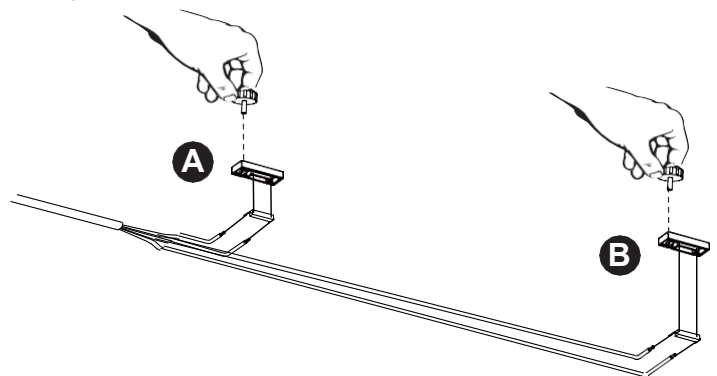

Maintenance:

Conduct the following operations at least every 6 months.
If in high intensity of use, shorten the period in between.

Disconnect the power supply:

- (1) Clean and lubricate the screws, the pins, and the hinge with grease.
- (2) Check the fastening points are properly tightened.
- (3) Make the wire connection are in good condition.

Connect the power supply:

- (1) Check the power adjustments.
- (2) Check the function of the manual release.
- (3) Check the function of photocells or other safety devise.

PART B:

GTR500 & GTR501

GTR502 & GTR503

Control System User Manual

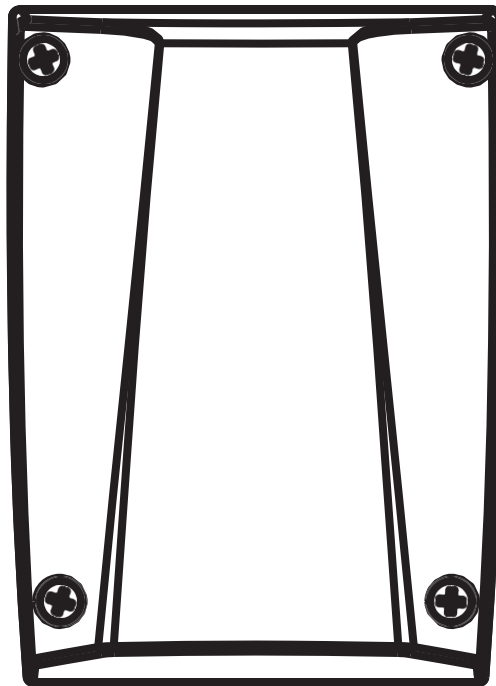

Control Box Installation

1. Decide the installation position of control box first, it is suggested to be installed near the gate and should be protected from possible damage. Be aware of the motor cable length before deciding the installation position.
2. Remove the cover by unscrewing the four screws on the cover. See Figure A.
3. Use a screwdriver to puncture the holes beneath the bottom of the control box. See Figure B.
4. Secure it on the wall Figure C.

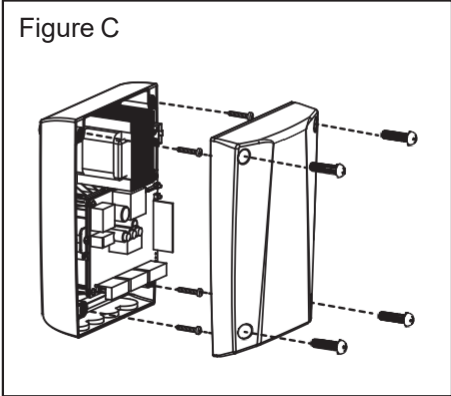
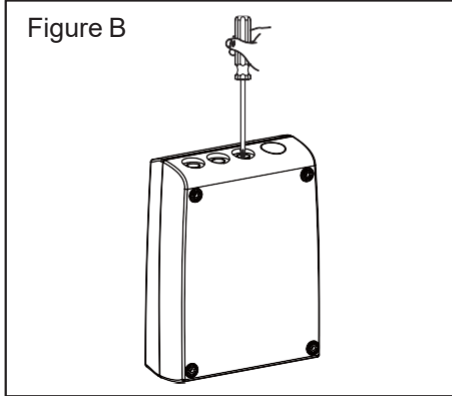
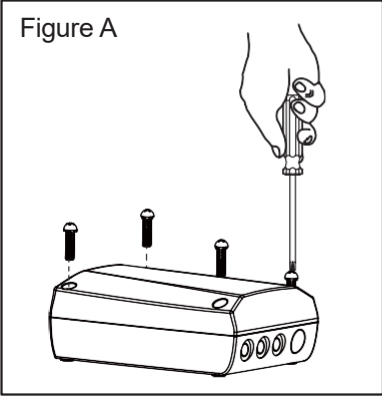

Wiring Connection

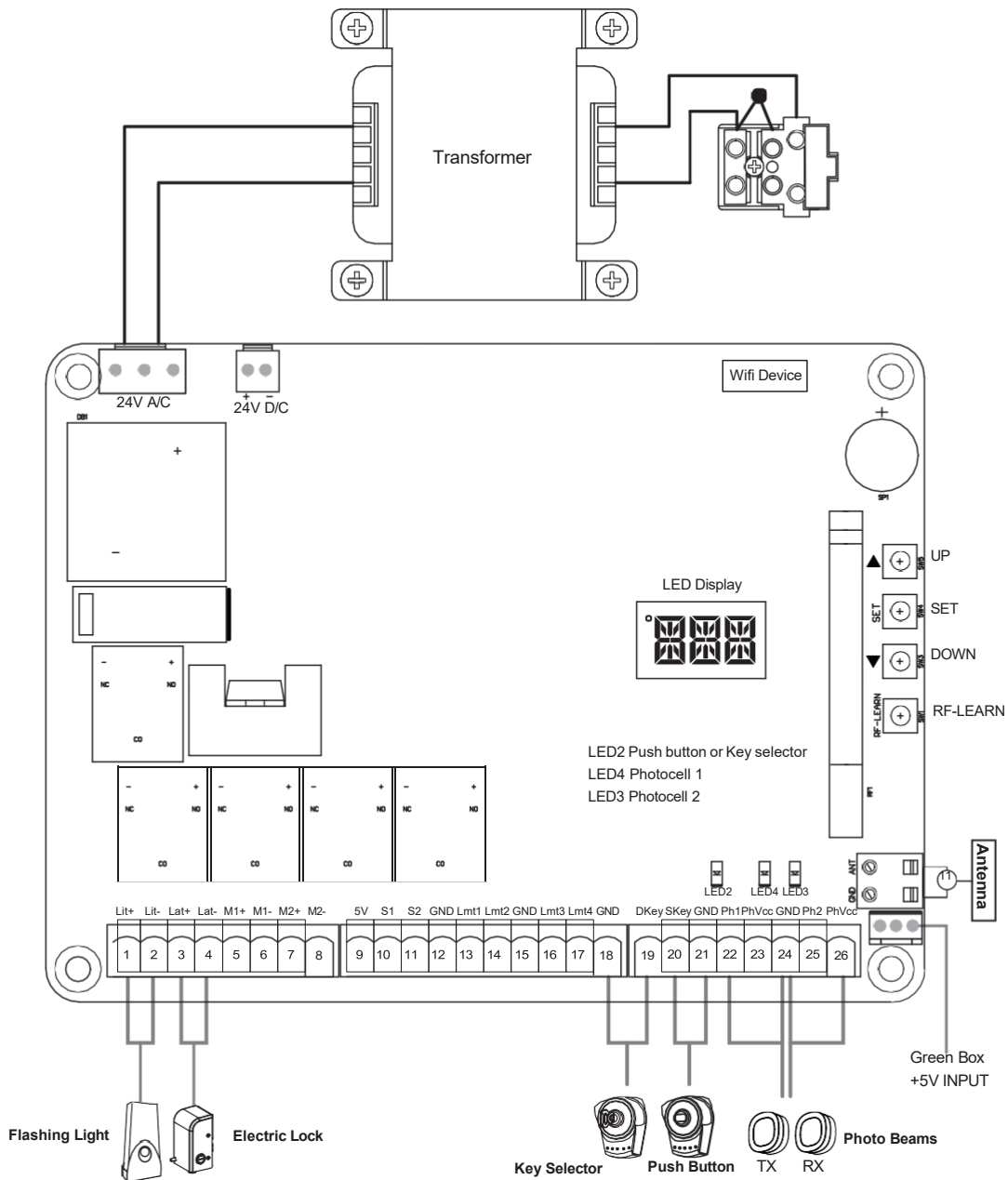

Motor Connection

A Motor with Limit Switch + LED Indicator

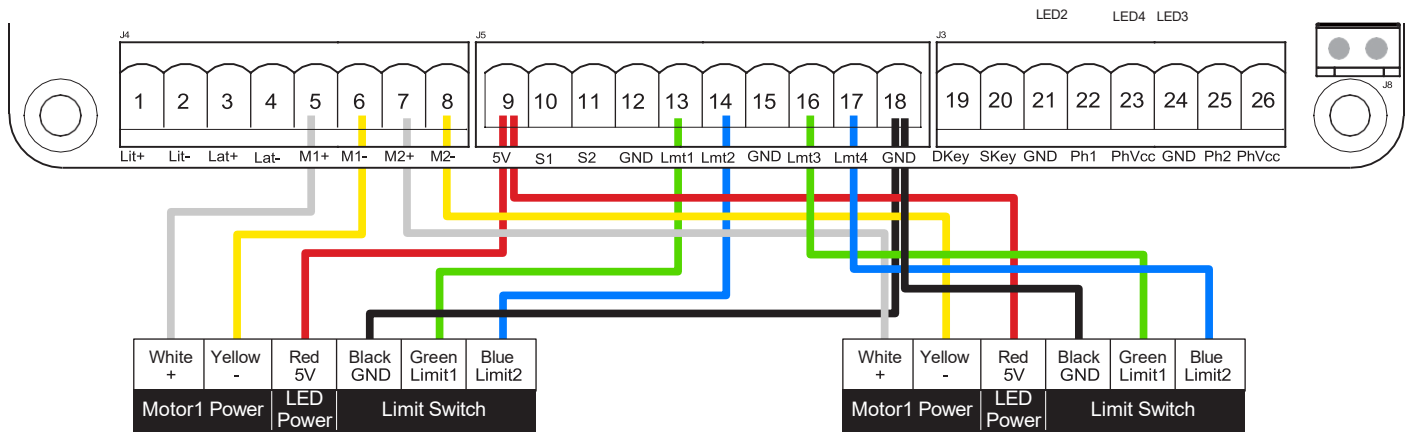

Get Started

Note:

(A) Remote learning must be done before system learning.

(B) **Verifying the GATE CONDITION.**

- 1) Release the gear with the release key and move the gate to the middle so the gate can move in both opening and closing directions; then lock the gear.
- 2) Operate the gate to opened and closed position several times and make sure the gates touches the limit switch at least 2~3 cm before the mechanical stop.

Step 1: Remote Learning

A. Learning

1. Press "RF Learn" button for 3 seconds, and the LED display shows "CS". Then press any desired button on the remote; the LED display will blink "CS" three times and stay on. After 7 seconds without any new remote learn then the LED will be off. The transmitter learning is completed.

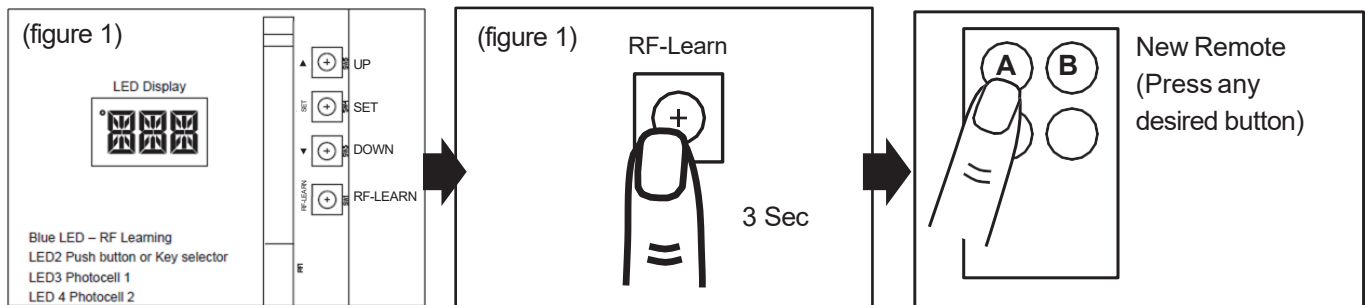

B. Remote Learning without Control Board:

- (1) Press the A & B buttons on the OLD remote and hold down for at least 5s, then release them. (the alarm will buzz 2 secs, and LED will display "CS")
- (2) Press any desired button on the NEW remote within 10 seconds (the alarm will buzz 3 times, LED blinks "CS" for 3 times)

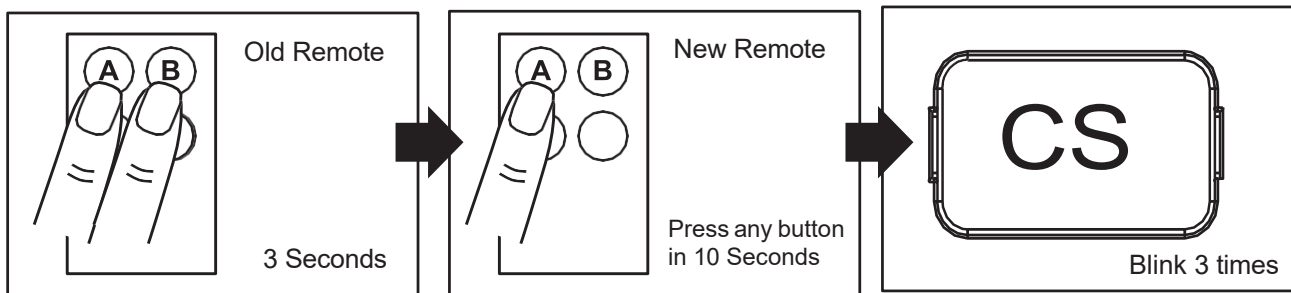

C. Deleting All Memory of All Remotes:

With this operation all the memorized transmitters will be deleted.

- (1) Press and hold down RF-LEARN button (Figure 4) on the control board for 10 seconds.
- (2) Wait until the LED display shows "CC". All memory is deleted.

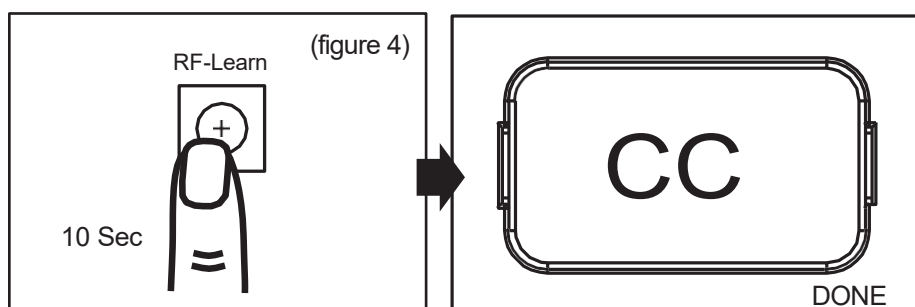

3.2 Step 2: System Learning

**Note – Before performing system learning, check your system parameters.
“F1” should be set to single or double (factory default is double)**

“F2” should be set to “F22” limit switches, unless open/close ground stoppers are used.

Step1:

Press and hold SET & DOWN buttons for 3 secs, until the LED shows “LEA”.

Within 20 seconds, press the paired button on your remote, or the set button on the PC board.



Dual Gate

(1) Slave Gate Close → (2) Master Gate Close → (3) Master Gate Open →
(4) Slave Gate Open → (5) Slave Gate Close → (6) Master Gate Close

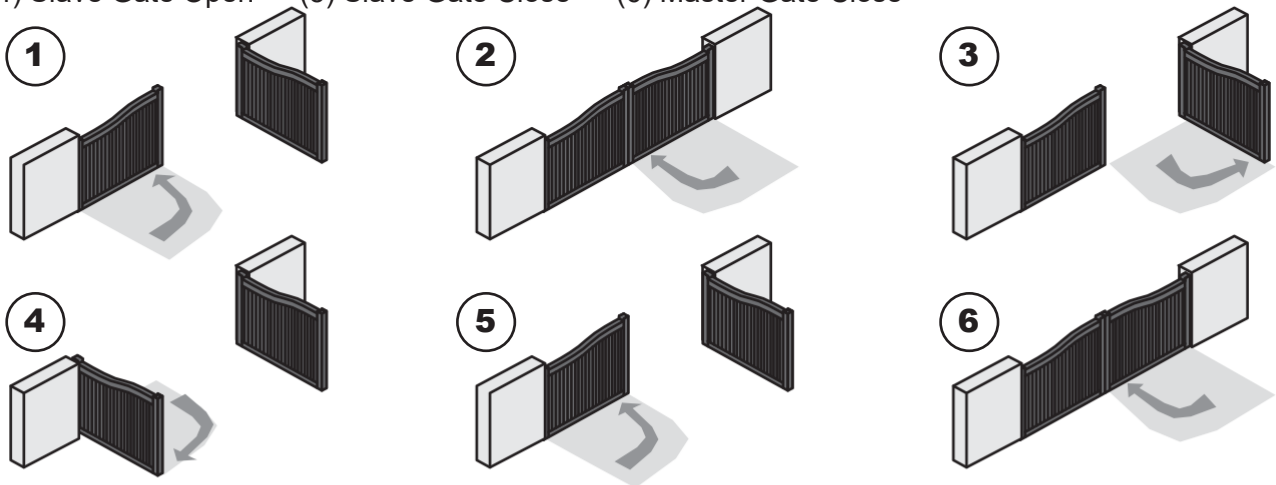

Single Gate :

(1) Master Gate Close → (2) Master Gate Open → (3) Master Gate Close

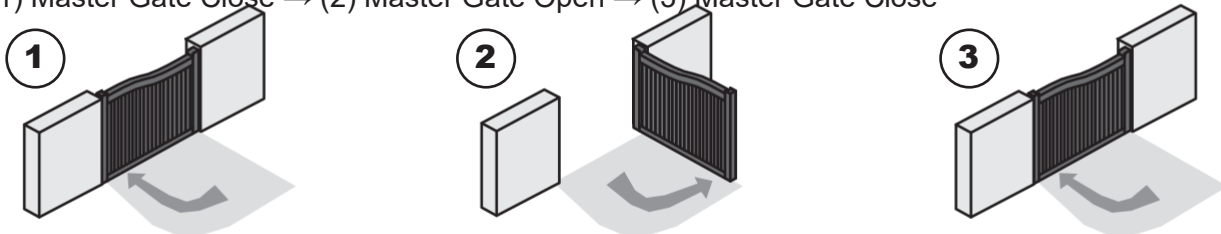

Restore system default setting

Press and Hold the UP + DOWN button for 5 secs and panel restores back to default setting.

Note:

1. LED shows "D-G" when the system, learning has been completed for Dual Gate installation.
2. LED shows "S-G" when the system, learning has been completed for Single Gate installation.

Gate-moving Logic

- (A) In gate-opening phase: The gates stop if the transmitter/push button/key selector is activated, and close when the transmitter/push button/key selector is reactivated.
- (B) In gate-closing phase: The gates stop if the transmitter/push button/key selector is activated, and open when the transmitter/push button/key selector is reactivated.
- (C) In gate-opening or gate-closing phase: For safety purpose, the gates stop if encountering obstacles.

Checking the Gate Movement

- 1). Release the gear with the release key and move the gate to the middle so that it can move in both opening and closing directions; then lock the gear.
- 2). Operate the gate to opened and closed position several times, and make sure the gates reaches the limit switch at least 2~3 centimeters before the mechanical stop.

LED Indication

LED2 D Key/S Key Key selector, or the push button is activated, LED2 will be on.

LED4 Ph1 LED4 will be on when Ph1 are triggered.

LED3 Ph2 LED3 will be on when Ph2 are triggered.

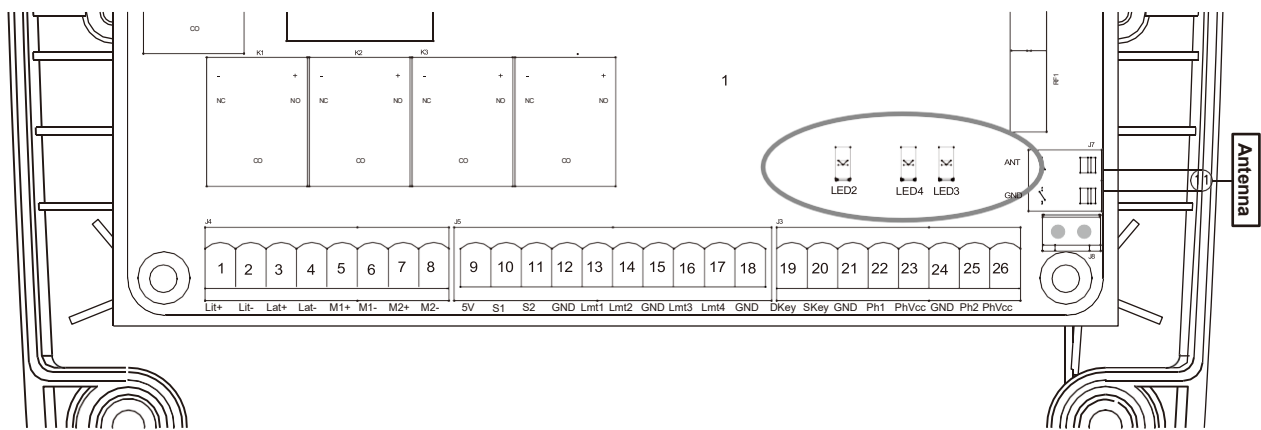

Function Of The LED Display

LED Display	Programmable Functions	LED Display	Programmable Functions
	[LEA] means motor into the system learning mode, do not interrupt during this procedure.		When the gate is stopped, the LED Display show 'STP' until next commend has been made, after 10s no further movement, the LED turns to OFF
	[D-G] means motor completed the learning procedure for dual gate installation.		When the gate is closing, the LED Display show 'CLS' for 2s and then change to Amp current indication
	[S-G] means motor completed the learning procedure for single gate installation.		LED display shows "S01" means the panel did not detected the M1+/M1 and M2+/M2 both been connected before the system learning procedure, check for motor wire connection, for dual gate system
	[N-L] means system learning failed.		LED display shows "S02" means the panel did not detected the M1+/M1 but detected M2+/M2 been connected, notice the installer to check the motor wire connection, if this is single gate system, motor wire should connect to M1+/M1 not on M2+/M2
	The memory of the system is all deleted/cleaned by press and hold the UP + SET+ DOWN button together for 5s and the panel will be back to default settings		LED display show "S03" means same button on the remote has been identified for more than 2 functions
	When the gate is opening, the LED Display show 'OPN' for 2s and then change to Amp current indication		

Parameter

Parameter Learning

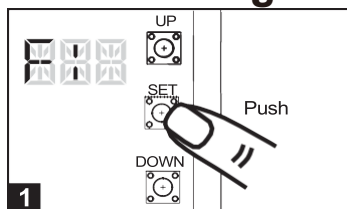

1 Press "SET" for 3 secs to get into the program setting display from F1

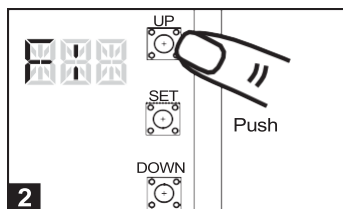

2 Press "UP" or "DOWN" to change setting items from F1 to FW.

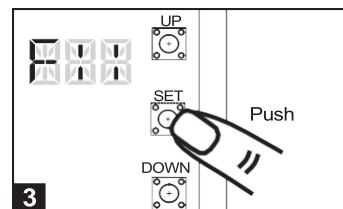

3 Press "SET" button again to get into the sub-setting

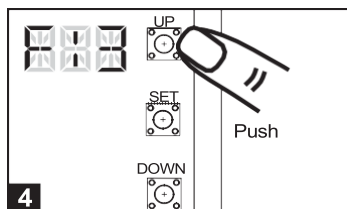

4 Press "UP" for "DOWN" to change from F11 to F12

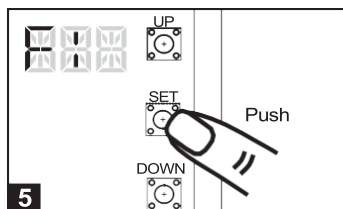

5 Press "SET" button again to confirm

Parameter Setting

LED Display	Definition	Parameter	Table	Description
F1	Dual / Single Gate	F11	Single Gate	1. The factory setting is "F12"
		F12	Dual Gate (Default)	
F2	Motor Type	F21	Ground Stopper (Default)	1. The factory setting is "F21"
		F22	Adjustable Limit Switch	
		F23	Hall Sensor	
F3	Overcurrent for Gate Opening	F31	2A	1. The factory setting is "F33".
		F32	3A	
		F33	4A (Default)	
		F34	5A	
		F35	6A	
		F36	7A	
F4	Overcurrent for Gate Closing	F41	2A	1. The factory setting is "F43".
		F42	3A	
		F43	4A (Default)	
		F44	5A	
		F45	6A	
		F46	7A	
F5	Motor Speed for Opening	F51	50% of full speed	1. The factory setting is "F55".
		F52	60% of full speed	
		F53	70% of full speed	
		F54	80% of full speed	
		F55	90% of full speed (Default)	
		F56	100% of full speed	
F6	Motor Speed for Closing	F61	50% of full speed	1. The factory setting is "F65".
		F62	60% of full speed	
		F653	70% of full speed	
		F564	80% of full speed	
		F65	90% of full speed (Default)	
		F66	100% of full speed	

LED Display	Definition	Parameter	Table	Description
F7	Deceleration Speed for Opening	F71 F72 F73 F74	20% of full speed 30% of full speed 40% of full speed (Default) 50% of full speed	1. The factory setting is "F73".
F8	Deceleration Speed for Closing	F81 F82 F83 F84	20% of full speed 30% of full speed 40% of full speed (Default) 50% of full speed	1. The factory setting is "F83".
F9	Deceleration Point for Opening	F91 F92 F93 F94 F95	75% of full distance 80% of full distance 85% of full distance (Default) 90% of full distance 95% of full distance	1. The factory setting is "F93".
FA	Deceleration Point for Closing	FA1 FA2 FA3 FA4 FA5	75% of full distance 80% of full distance 85% of full distance (Default) 90% of full distance 95% of full distance	1. The factory setting is "FA3".
FB	Time Gap b/w Two Gates (Opening)	FB0 FB1 FB2 FB3 FB4 FB5 FB6 FB7 FB8 FB9	0 sec 4 sec 6 sec 10 sec 15 sec 20 sec 25 sec 30 sec 35sec	1. The factory setting is "FB1".
FC	Time Gap b/w Two Gates (Closing)	FC0 FC1 FC2 FC3 FC4 FC5 FC6 FC7 FC8 FC9	0 sec 2 sec (Default) 4 sec 6 sec 10 sec 15 sec 20 sec 25 sec 30 sec 35 sec	1. The factory setting is "FC1".
FD	Auto-closing	FD0 FD1 FD2 FD3 FD4 FD5 FD6 FD7 FD8	Function OFF (Default) 3 sec 10 sec 20 sec 40 sec 60 sec 120 sec 180 sec 300 sec	1. Auto-close mode activates when the gates move to the end position or stopped manually. If the transmitter, push button, or the key selector is activated before the auto-close counting, the gate will close immediately. 2. The factory setting is "FD0".

LED Display	Definition	Parameter	Table	Description
FE	Safety Device Function Mode	FE1 FE2 FE3 FE4	Mode 1 (Default) Mode 2 Mode 3 Mode 4	1. Please see P.19 photocell adjustment for photocell logic 2. The factory setting is "FE1".
FF	Pedestrian Mode	FF0 FF1	Function OFF Function ON (Default)	1. The factory setting is "FF1". 2. When it's set "FF0": there won't be any response while pressing remotes & D/Skey terminals 3. When it's set "FF1": *single gate installation >> master gate fully opens *dual gate installation >> master gate opens 50%
FG	Flashing Light	FG0 FG1	Function OFF (Default) Function ON	1. When function FG1, the light will flash for 3 seconds before the gate operates. If set OFF, the flash light will operate with motor at the same time. 2. The factory setting is "FG0".
FH	Photocell 1 Activation	FH0 FH1	Function OFF (Default) Function ON	1. The factory setting is "FH0".
FI	Photocell 2 Activation	FI0 FI1	Function OFF (Default) Function ON	1. The factory setting is "FI0".
FJ	Alarm Buzzer	FJ0 FJ1	Function OFF (Default) Function ON	1. The factory setting is "FJ0".
FK	Electric Latch Mode	FK1 FK2	Standard Gate Opening (Default) Release Gate Tension before Opening (Gate Reversing for 0.25s)	1. If the function is FK2, the motor will be reversed for 0.25 sec. to release the tension. 2. The factory setting is "FK1".
FL	LED Direction	FL0 FL1	When Terminal Block is at bottom (for swing gate motor) When Terminal Block is at top (for articulated-arm motor >> Default)	1. The factory setting is "FL1". The UP(▲) and Down(▼) buttons will switch according to the parameter setting. When FL0, button SW5 stands for ▲(UP) , and button SW3 stands for ▼(DOWN). When FL1, button SW3 stands for ▲(UP) , and button SW5 stands for ▼(DOWN)
FM	Over Current Reverses Time when Close	FN0 FN1 FN2 FN3 FN4 FN5 FN6	Function OFF (Default) 0.1 sec 0.2 sec 0.3 sec 0.4 sec 0.5 sec 0.6 sec	1. The factory setting is "FN0"
FN	A Button Function (Remote)	FO0 FO1 FO2 FO3 FO4	Function OFF Open-Stop-Close-Stop (Default) Pedestrian Mode Turn auto-closing OFF via remote Open ONLY	1. The factory setting is "FO1"
FP	B Button Function (Remote)	FP0 FP1 FP2 FP3 FP4	Function OFF Open-Stop-Close-Stop Pedestrian Mode (Default) Turn auto-closing OFF via remote Open ONLY	1. The factory setting is "FP2"
FR	C Button Function (Remote)	FR0 FR1 FR2 FR3 FR4	Function OFF (Default) Open-Stop-Close-Stop Pedestrian Mode Turn auto-closing OFF via remote Open ONLY	1. The factory setting is "FR0"
FS	D Button Function (Remote)	FS0 FS1 FS2 FS3 FS4	Function OFF (Default) Open-Stop-Close-Stop Pedestrian Mode Turn auto-closing OFF via remote Open ONLY	1. The factory setting is "FS0"

LED Display	Definition	Parameter	Table	Description
FT	D Key Function (PCB Terminal)	FT1 FT2 FT3 FT4 FT5	PB Function: Open-Stop-Close-Stop (Default) Open ONLY Pedestrian Mode Close ONLY Fire Alarm Mode	1. The factory setting is "FT1" 2. Fire Alarm Mode: * Terminal Detect NO - normal operation * Terminal Detect NC - Open the gate and lock all the functions before returning to NO
FU	S Key Function (PCB Terminal)	FU1 FU2 FU3 FU4 FU5	PB Function : Open-Stop-Close-Stop (Default) Open ONLY Pedestrian Mode Close ONLY Fire Alarm Mode	1. The factory setting is "FU1" 2. Fire Alarm Mode: * Terminal Detect NO - normal operation * Terminal Detect NC - Open the gate and lock all the functions before return to NO
FW	Over current Sensitivity Setting	FW1 FW2 FW3 FW4 FW5 FW6 FW7 FW8 FW9 FWA	0.1 sec 0.2 sec 0.3 sec 0.4 sec 0.5 sec (Default) 0.6 sec 0.7 sec 0.8 sec 0.9 sec 1 sec	1. The factory setting is "FW5"

Photocell Logic

FE1 Photocell OPEN/CLOSE (Standard set up)

Position of Gate	When safety devices are activated	
	PH1 Photocell-CLOSE	PH2 Photocell-OPEN
Type of Safety Device		
FULLY CLOSED	No effect	Open not allowed
FULLY OPENED	Reload automatic closing time	No effect
STOP DURING MOVING	Reload automatic closing time	Open not allowed
CLOSING	Open	No effect
OPENING	No effect	Close

FE2 Safety Edge

Position of Gate	When safety devices are activated	
	PH1 Photocell-CLOSE	PH2 Safety Edge
Type of Safety Device		
FULLY CLOSED	No effect	Open not allowed
FULLY OPENED	Reload automatic closing time	
STOP DURING MOVING	Reload automatic closing time	OPEN/CLOSE not allowed
CLOSING	Open	Reverse to open for 2 seconds
OPENING	No effect	Reverse to close for 2 seconds

FE3 Open Only Device (Vehicle detector)

Position of Gate	When safety devices are activated	
Type of Safety Device	PH1 Opening Device	PH2 Photocell-CLOSE
FULLY CLOSED	Open	No effect
FULLY OPENED	Reload automatic closing time	
STOP DURING MOVING	Open	Reload automatic closing time
CLOSING	Open	Open
OPENING	No effect	No effect

FE4 Double photocell set up

Position of Gate	When safety devices are activated	
Type of Safety Device	PH1 Photocell-OPEN/CLOSE	PH2 Photocell-OPEN/CLOSE
FULLY CLOSED	No effect	No effect
FULLY OPENED	Reload automatic closing time	
STOP DURING MOVING	Reload automatic closing time	
CLOSING	Open	Open
	No effect	No effect

Technical Specification

Main power supply	230Vac/110Vac, 50Hz/60Hz
Back-up battery	2pcs of batteries for emergency operation, 2.2A each (Sold Separately)
Receiver board	433.92MHz; 200 transmitters memory
Installation	Wall mounted vertically
Operating Temperature	-20°C~+50°C
Dimension	275mm * 195mm * 102mm

Trouble Shooting

Issue:	Solution:	Parts to look at:
No power on the board.	<ul style="list-style-type: none"> - Power to the transformer is on and the connector block from the AC power lead to the transformer and to the control board is wired correctly. - At the control board check the transformer white connector blocks are correctly plugged into board and the battery connector if equipped. - Check fuses are both working. * 15amp for stand-alone transformer. - Check there is 24vac into and out of the Control box fuse. - The batteries are connected to the control board and read higher than 24vdc if equipped. - Try removing optional extras such as beams and probes to see if they are draining the power. And reset the control panel to default and testing the motor operation 	<ul style="list-style-type: none"> - Fuse - Transformer power - Loose wires - Incorrect wire contact at connector blocks - Short circuit in wiring between transformer and board - Battery
A single arm activation isn't working.	<ul style="list-style-type: none"> - Check function setting is set correctly for single arm. FI-1 single gate mode. FB-1 Pedestrian mode to be ON. Using button B on the remote to operate the single gate. - Make sure the arm is connected to motor 1 and not motor 2. - Your remote is programmed in. - You have done a systems learn. - There is adequate power going to the board. 	<ul style="list-style-type: none"> - Motor connection - Function setting for single mode
Remotes or wireless keypad not working.	<ul style="list-style-type: none"> Re-program remotes by pressing the RF-Learn button on the control board. - You can program in several remotes or devices at a time however all signals need to be sent before the blue light goes off again. - Push the button fairly solid and hold it in for a whole second. The blue light should flicker. - If the blue light is on continuously without pressing the RF learn button it means the receiver is faulty and needs to be replaced. - The blue light will still flash when a remote that has not been programmed in is used. It will however not activate. - Reset the keypad. Do this by flicking off the front cover with a small screw driver. Undo the 2 nuts, turn over and repeat until left with the control board on the casing. Undo the 3 screws in the corner. Turn over the circuit board and there is a button there. Hold it until you hear a beep. Try keypad again and reassemble. 	<ul style="list-style-type: none"> - RF Learn button on control board
Lights on the board but arm(s) not moving.	<ul style="list-style-type: none"> - Check the LED3 and LED4 on the board are off, which is located on the button right of the board if it is on check the photocell connection and function - Check that the battery is 24V+. - Make sure your connections aren't loose. - The power input is feeding in 24V+. - The gate is free from any obstructions. - The arm is locked into place (A good way to test this is if you can move the gate freely, then it won't work via the motors). - Try depowering and repowering the board. - If it still keeps glowing please call or email us. Receiver may need replacement. 	<ul style="list-style-type: none"> - The gate - Power sources - Arm wires.
Gates remain open after systems learn/one arm stays open and the other one closed.	<ul style="list-style-type: none"> - Ensure you have matched the + and - of each ram to the equivalent + and – motor symbols on the board. - Change the polarity connection of the positive(+) with the negative(-) of the motor if the gate both stay open instead of close after the system learning - Clear any obstructions to the gates. - Make sure that the arms are going no further than 100 degrees. - The function setting should be set for a double swing and not a single. - Check the LED display during the system learning showing the motor current, once the reading is too high check the installation or the gate condition . - Ensure the motors are locked in. - Increase the power amp settings by function setting F2 for open and F3 for close direction (mentioned above). 	
Gates not fully opening or closing	<ul style="list-style-type: none"> - Ensure there is nothing obstructing the gate or the arms. - If the gate is a bigger or heavier gate change the power settings using the F2 for open and F3 for close direction. You should not have to use the maximum power setting. This is intended for a 500kg double swing gate (or 250kg single). - Re-do the systems learn. 	
One gate opens part of the way/not at all.	<ul style="list-style-type: none"> - Make sure you are pressing the top left hand button. The other buttons do have their individual functions. - Check the FB function for pedestrian mode, set to FB-0 if you require the single gate to be fully open instead of partial open - Both arms are wired onto the control board correctly. They should be identical. I.E. black, red. Black, red. 	
Remote/ keypad range is less than 20M	<ul style="list-style-type: none"> - Make sure the antenna is attached and screwed in on the control board. - Make sure there is nothing obstructing the antenna such as the power cable or motor cables. 	

Technical Support

For support or assistance with installing your gate motor, visit gatesupport.richmondau.com

Or ring your local Richmond Wheel & Castor Branch

AU: 1300 474 246 **NZ:** 0800 61 71 81 **International:** +613 9551 2233

Richmond Wheel & Castor Co. declines all responsibility for any consequences resulting from improper use of the product, or use which is different from the expected and specified in the present documentation.

Richmond Wheel & Castor Co. declines all responsibility for any consequences resulting from failure to observe Good Technical Practice when constructing closing structures (door, gates etc), as well as from any deformation which might occur during use.